

Features

- APPLUS approved in compliance with EN54-17 EN54-18 standards
- ONEPROTOCOLL communication protocol
- Isolator integrated in each device
- Manual addressing via the ONEPROGRAMMER programmer
- Reading of the voltage value at the terminals of the addressed devices
- 240 addresses available per loop (remember that each multi-module occupies several addresses depending on the model)
- Three-colour LED (red / green / yellow) controlled by the control unit
- **ONEMODULE001** Certificate n°0370-CPR-3642
- **ONEMODULE100** Certificate n°0370-CPR-3642
- **ONEMODULE110** Certificate n°0370-CPR-3642
- **ONEMODULE111** Certificate n°0370-CPR-3642
- **ONEMODULE120** Certificate n°0370-CPR-3642
- **ONEMODULE300** Certificate n°0370-CPR-3642
- **ONEMODULE301** Certificate n°0370-CPR-3642
- **ONEMODULE310** Certificate n°0370-CPR-3642



Description

The new series of analogue multi modules of the **ONEMODULE** line implements supervision and monitoring functions for the activation and supervision of auxiliary devices.

Each **ONEMODULE** can be addressed manually, by ONEPROGRAMMER programmer or by fire detection control unit with ONEPROTOCOLL protocol.

The input channels monitor the rest, alarm and fault condition through the balancing resistors provided.

The output channels can be either monitored or formC type. In the case of monitored output, the end of line (cut, short cables) and the presence of the power supply on the load, supplied with end-of-line resistance and diode are checked.

In the case of formC output, the module offers potential-free relay contacts.

Guaranteed communication

The **ONEMODULE** series modules are equipped with an integrated short-circuit isolator.

This means that in the event of a failure on a loop or on a single device, communication with the devices themselves is not interrupted.

Thus greater system reliability is guaranteed.

Simplified installation

The installation of **ONEMODULE** is very simple, the programming of the addresses takes place via the ONEPROGRAMMER programmer, no DIP switches or rotary switches are used.

The **ONEMODULE** modules offer a combination of inputs and outputs in a single container thus allowing to save on the assembly and cost of the cables compared to single modules.

Obviously **ONEMODULE** will always occupy a number of addresses given by the type of module purchased.

Construction

The **ONEMODULE** range is made of matt white ABS.

It is equipped with extractable terminal blocks both towards the loop and towards the field.

It is possible to use cables with a maximum section of 2.5mm

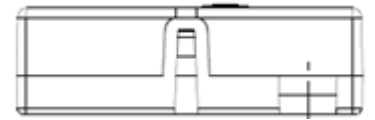
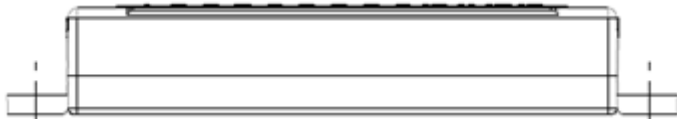
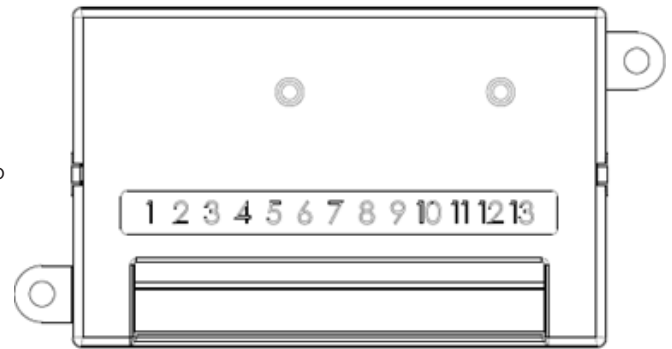

Approvals and Compliance

The entire **ONEMODULE** range is APPLUS certified according to the EN54 standard parts 17 and 18.

Codes

Code	Description
ONEMODULE001	1 monitored output
ONEMODULE100	1 supervised input
ONEMODULE110	1 supervised input + 1 formC output
ONEMODULE111	1 supervised input + 1 formC output + 1 monitored output
ONEMODULE120	1 supervised input + 2 formC outputs
ONEMODULE300	3 supervised inputs
ONEMODULE301	3 supervised inputs + 1 monitored output
ONEMODULE310	3 supervised inputs + 1 form C output

Technical specifications

Item	ONEMODULE001	ONEMODULE100	ONEMODULE110	ONEMODULE111
Type	1 monitored output	1 supervised input	1 supervised input + 1 formC output	1 supervised input + 1 formC output + 1 monitored output
Compliance	EN54-17, EN54-18	EN54-17, EN54-18	EN54-17, EN54-18	EN54-17, EN54-18
N° of addresses	1	1	2	3
Certifying body	APPLUS			
Protocol	ONEPROTOCOL			
Loop	Up to 240 addresses available along 5Km cable*.			
Supply voltage	18 - 27V			
Stand by current	180µA			
LED power consumption	6mA (LED on)			
Relay output	1 A**			
Operating temperature	-5°C - +40°C			
Humidity	95% RH (without condensation)			
Dimensions	106x54x27 mm			
Weight	100g			

Item	ONEMODULE120	ONEMODULE300	ONEMODULE301	ONEMODULE310
Type	1 supervised input + 2 formC outputs	3 supervised inputs	3 supervised inputs + 1 monitored output	3 supervised inputs + 1 form C output
Compliance	EN54-17, EN54-18	EN54-17, EN54-18	EN54-17, EN54-18	EN54-17, EN54-18
N° of addresses	3	3	4	4
Certifying body	APPLUS			
Protocol	ONEPROTOCOL			
Loop	Up to 240 addresses available along 5Km cable*			
Supply voltage	18 - 27V			
Stand by current	180µA			
LED power consumption	6mA (LED on)			
Relay output	1 A**			
Operating temperature	-5°C - +40°C			
Humidity	95% RH (without condensation)			
Dimensions	106x54x27 mm			
Weight	100g			

*note : subject to load calculations and use of appropriate cables

**note : not for ONEMODULE300